

Eliot Scott
385T Lab Methods - Instructor Karen Pavelka
Condition Report - 5/3/2011

Description and Condition

Primary(hxw):	18 ^{1/4} x 24 ^{1/4} inches 46.5 x 62 cm	Image Area (hxw):	16 ^{1/4} x 20 ^{1/4} inches 41.5 x 51.75 cm
----------------------	--	--------------------------	---

Content:

Title: Appendix B. Plan of the Entrance Story of the Office for the Public Records of Scotland

From: Engraved for the Report on the Public Records of the Kingdom Etc.

Date: Ordered to be printed 7/4/1800, re-printed 1803

Printers: Luke Hansard & Sons Printers

Content: Architectural layout for the Office of the Public Records of Scotland, Entrance Story.

Dark Shades represent finished, while light shades represent unfinished.

General: Monochrome intaglio ink engraving on probably mould made quality paper.

Media: Monochrome black Intaglio ink from gray to black. Ink is slightly lighter on border in upper left corner. Slightly lighter or missing ink along border on all sides. Crack in ink from primary support 9.5 cm from top/32 cm from left - fill applied. Stains on primary support causing ink discoloration along center fold (see below). Ink lightening 31.5cm from top/ 32cm from left.

Primary Support: Likely mould made western paper. No tears or losses. Object has been dry-cleaned with eraser crumbs and humidified in a humidity chamber. Crack with slight loss at 9.5 cm from top/32 cm from left due to crease has been filled. Other fills at bottom center (0/31cm from left) and top-right (6cm from top/46cm from left). Object has deckled edges on the right and left with cut edges on the top and bottom. Foxing at top left (0-10cm from top/10-30cm from left), along entire bottom left edge and minor foxing along right edge. Slight planar deformation on entire object with more distinct cockling along top right edge and bottom left edge extending to the center.

Distinct planar deformation with slight crease and slight brownish discoloration or darkening along entire height of document at center (~31cm). Slight crease in addition to fold along height of object has been humidified and mended with tissue paper and natural adhesive for support along part of object back. Large (~9x3.5cm) oval shaped stain at top center with distinct tidelines along fold. Smaller(~8x3cm) less distinct brown stain with slight tideline 22cm from top center along fold. Brown stain on bottom center with thinning and cockling, mended for support with fill added. Slight tideline along top right corner with slight discoloration.

B. PLAN of the Entrance Story of the OFFICE for the Public Breeds of SCOTLAND.

In this Plan, dashed black lines which are furnished to the light, show what conveniences are to be furnished.

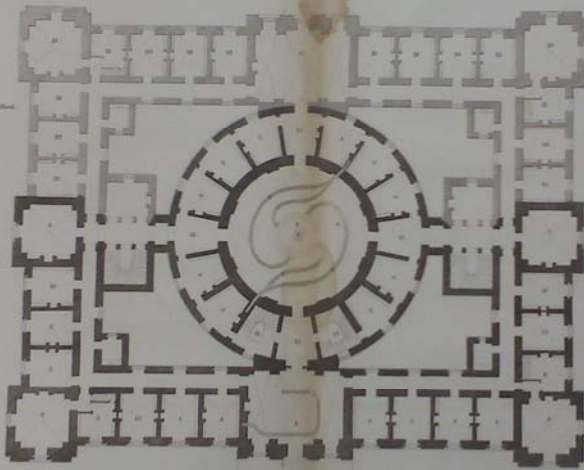

- EXPLANATION**
In the Plan of the Building here is intended
1. Hall
 2. Office
 3. Office
 4. Office
 5. Office
 6. Office
 7. Office
 8. Office
 9. Office
 10. Office
 11. Office
 12. Office
 13. Office
 14. Office
 15. Office
 16. Office
 17. Office
 18. Office
 19. Office
 20. Office
 21. Office
 22. Office
 23. Office
 24. Office
 25. Office
 26. Office
 27. Office
 28. Office
 29. Office
 30. Office
 31. Office
 32. Office
 33. Office
 34. Office
 35. Office
 36. Office
 37. Office
 38. Office
 39. Office
 40. Office
 41. Office
 42. Office
 43. Office
 44. Office
 45. Office
 46. Office
 47. Office
 48. Office
 49. Office
 50. Office
 51. Office
 52. Office
 53. Office
 54. Office
 55. Office
 56. Office
 57. Office
 58. Office
 59. Office
 60. Office
 61. Office
 62. Office
 63. Office
 64. Office
 65. Office
 66. Office
 67. Office
 68. Office
 69. Office
 70. Office
 71. Office
 72. Office
 73. Office
 74. Office
 75. Office
 76. Office
 77. Office
 78. Office
 79. Office
 80. Office
 81. Office
 82. Office
 83. Office
 84. Office
 85. Office
 86. Office
 87. Office
 88. Office
 89. Office
 90. Office
 91. Office
 92. Office
 93. Office
 94. Office
 95. Office
 96. Office
 97. Office
 98. Office
 99. Office
 100. Office

- EXPLANATION**
In the unshaded Part of the Building
1. Office
 2. Office
 3. Office
 4. Office
 5. Office
 6. Office
 7. Office
 8. Office
 9. Office
 10. Office
 11. Office
 12. Office
 13. Office
 14. Office
 15. Office
 16. Office
 17. Office
 18. Office
 19. Office
 20. Office
 21. Office
 22. Office
 23. Office
 24. Office
 25. Office
 26. Office
 27. Office
 28. Office
 29. Office
 30. Office
 31. Office
 32. Office
 33. Office
 34. Office
 35. Office
 36. Office
 37. Office
 38. Office
 39. Office
 40. Office
 41. Office
 42. Office
 43. Office
 44. Office
 45. Office
 46. Office
 47. Office
 48. Office
 49. Office
 50. Office
 51. Office
 52. Office
 53. Office
 54. Office
 55. Office
 56. Office
 57. Office
 58. Office
 59. Office
 60. Office
 61. Office
 62. Office
 63. Office
 64. Office
 65. Office
 66. Office
 67. Office
 68. Office
 69. Office
 70. Office
 71. Office
 72. Office
 73. Office
 74. Office
 75. Office
 76. Office
 77. Office
 78. Office
 79. Office
 80. Office
 81. Office
 82. Office
 83. Office
 84. Office
 85. Office
 86. Office
 87. Office
 88. Office
 89. Office
 90. Office
 91. Office
 92. Office
 93. Office
 94. Office
 95. Office
 96. Office
 97. Office
 98. Office
 99. Office
 100. Office

Scale of Feet

Printed by James Ballantyne, Edinburgh, 1841.

Designed by the ARCHT. for the Public Breeds in the Kingdom, &c.

John Ballantyne, Edinburgh, 1841.